

RUBIX

THE MINISTER
BUILDING EC3

A fully fitted space on the 7th floor with views overlooking Tower Bridge

The Minster building offers flexible office space with the option to take a fully fitted floor or a part floor, while still enjoying the wider amenities of the building. Following a recent high quality refurbishment the ground floor offers a stylish reception which sits within a full height atrium.



AMENITIES



24/7 ACCESS



FULL END OF TRIP FACILITIES



AIR CONDITIONING



FIBRE INSTALLED



MANNED RECEPTION



TERRACE



50 - 236 OPEN PLAN DESKS



EPC B



8 PASSENGER LIFTS

FLOOR PLAN

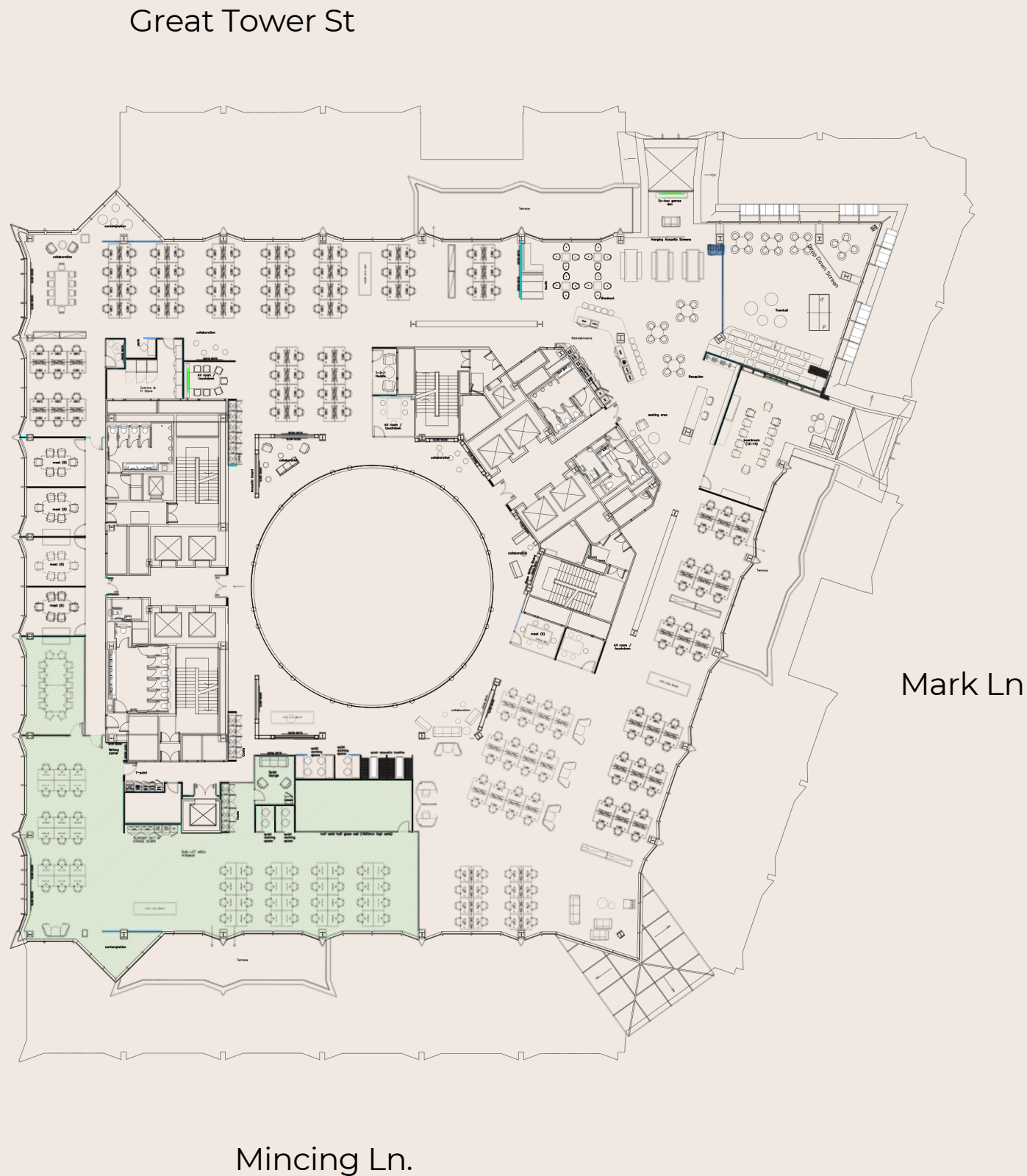

AVAILABILITY

FLOOR	SQ M	SQ FT	RENT/PSF	S.C/PSF	RATES/PSF	TOTAL/MONTH
7th	2136.39	22,996	£66.30	£18.09	£22.46	£204,760
P7th	388.30	4,180	£67.50	£18.09	£22.46	£37,637

TERMS: AVAILABLE AS AN ASSIGNMENT OR SUBLET OF THE WHOLE, OR SUBLET OF PART UNTIL AUGUST 2028.

KEY

236 open plan desks + hot desking options

Dedicated kitchen and casual dining space

Breakout areas and various phone booths

Large townhall space

12 + meeting rooms of varying sizes.

8 lifts and stairwell access

This iconic landmark building now offers a full floorplate with capacity for up to 250 desks, designed to accommodate a wide range of occupiers. Following a comprehensive refurbishment the building has been revitalised to deliver a contemporary, high-performing workspace in one of the most prime London locations.

A stunning glass atrium runs the length of the building, bringing natural light to all seven floors, and creating a sense of arrival and energy throughout the space. Premium end-of-trip amenities support modern working, including facilities for over 250 bikes, showers and changing areas.

THE CITY

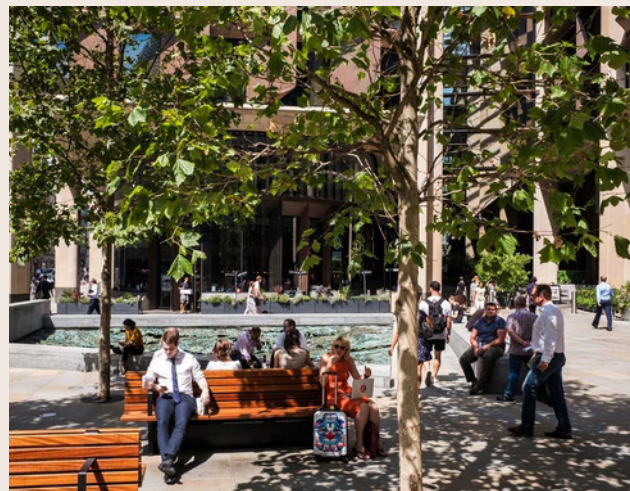

LOCATION

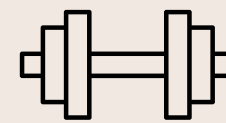
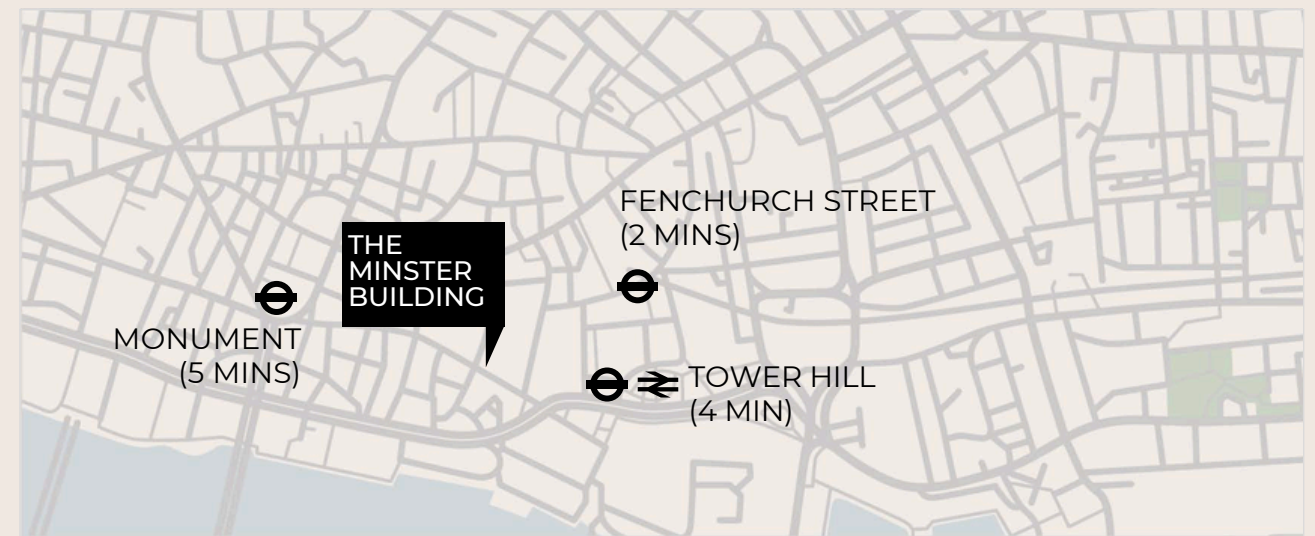

Third Space City
Roar Fitness
PureGym
The Gym Group
Fitness First

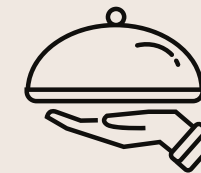

HAZ
Tank and Paddle
Darwin Brassiere
Fenchurch Restaurant
Wagtail
The Royal Exchange



Hawes and Curtis
Next
Leadenhall Market
One New Change

TALK TO US

Viewing is strictly by prior appointment with Rubix.

Harry Radcliffe

E: harry@rubix.london
M: +44(0)7796217354

Oliver Hawking

E: oliver@rubix.london
M: +44(0)7714 145 970

Poppy Taylor

E: poppy@rubix.london
M: +44(0)7713 630 101

Disclaimer - Rubix Real Estate Ltd for themselves and for the vendors or lessors of this property whose agents they are given notice that:- (1) The particulars are set out as a general outline for the guidance of the intending purchasers and do not constitute part of an offer or contract; (2) All descriptions, dimensions, references to condition and necessary permissions for use and occupation and other details are given without responsibility and any intending purchasers should not rely on them as standards or representations of fact but must satisfy themselves by inspection or otherwise as to the correctness of each of them; (3) No persons in the employment of Rubix Real Estate Ltd has any authority to make or give any representation or warranty whatsoever in relation to this property.