

LOCATION PLAN

owner
2310481 ONTARIO INC.
 1405 Denison Street
 Markham, Ontario, L3R 5V2

project name
INDUSTRIAL BUILDING
 241 King Street, Barrie, Ontario

WHEELWRIGHT GROUP INC.
 ENGINEERS AND CONTRACTORS
 110 FENMAR DRIVE
 TORONTO, ONTARIO, M9L 1M5
 TEL: (416) 741-2630
 FAX: (416) 741-9059

scale 1 : 400
 drawn DM
 date October 2022
 checked

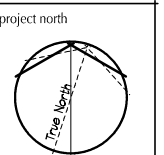

title
**MARKETING
 SITE PLAN**

project & drawing no.
 21-511
MSP-1

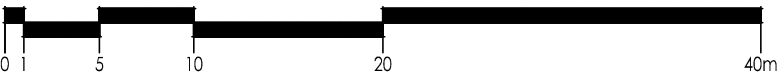

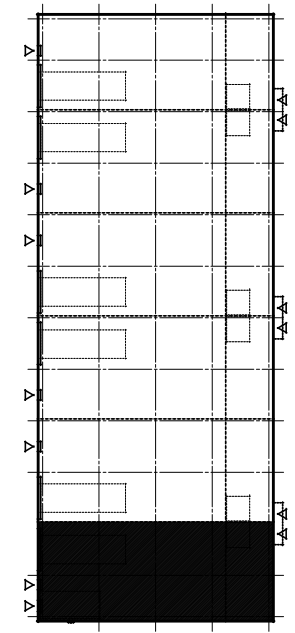
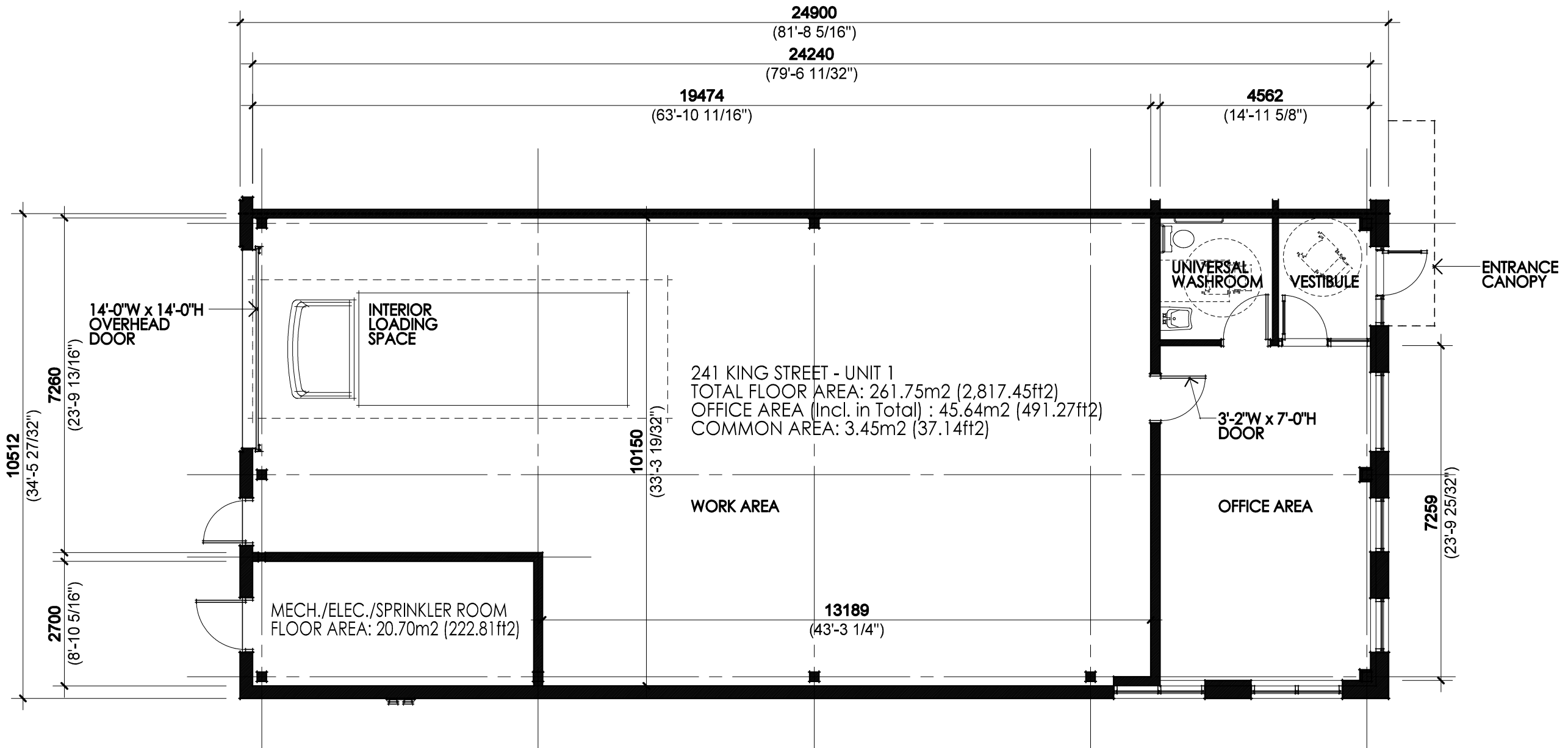

KEY PLAN

owner
2310481 ONTARIO INC.
 1405 Denison Street
 Markham, Ontario, L3R 5V2

project name
INDUSTRIAL BUILDING
 241 King Street, Barrie, Ontario

WHEELWRIGHT GROUP INC.
 ENGINEERS AND CONTRACTORS
 110 FENMAR DRIVE
 TORONTO, ONTARIO, M9L 1M5
 TEL : (416) 741-2630
 FAX : (416) 741-9059

scale 1 : 100
 drawn DM
 date October 2022
 checked

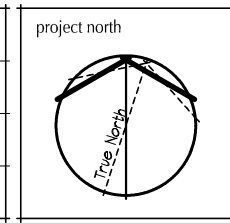

title
 MARKETING
 FLOOR PLAN
 UNIT 1

project & drawing no.
 21-511
MFP-1

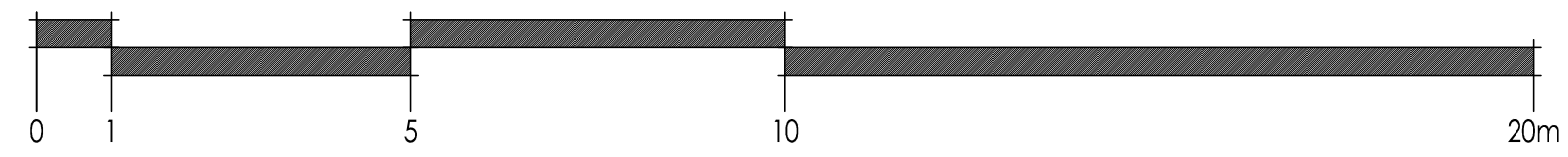

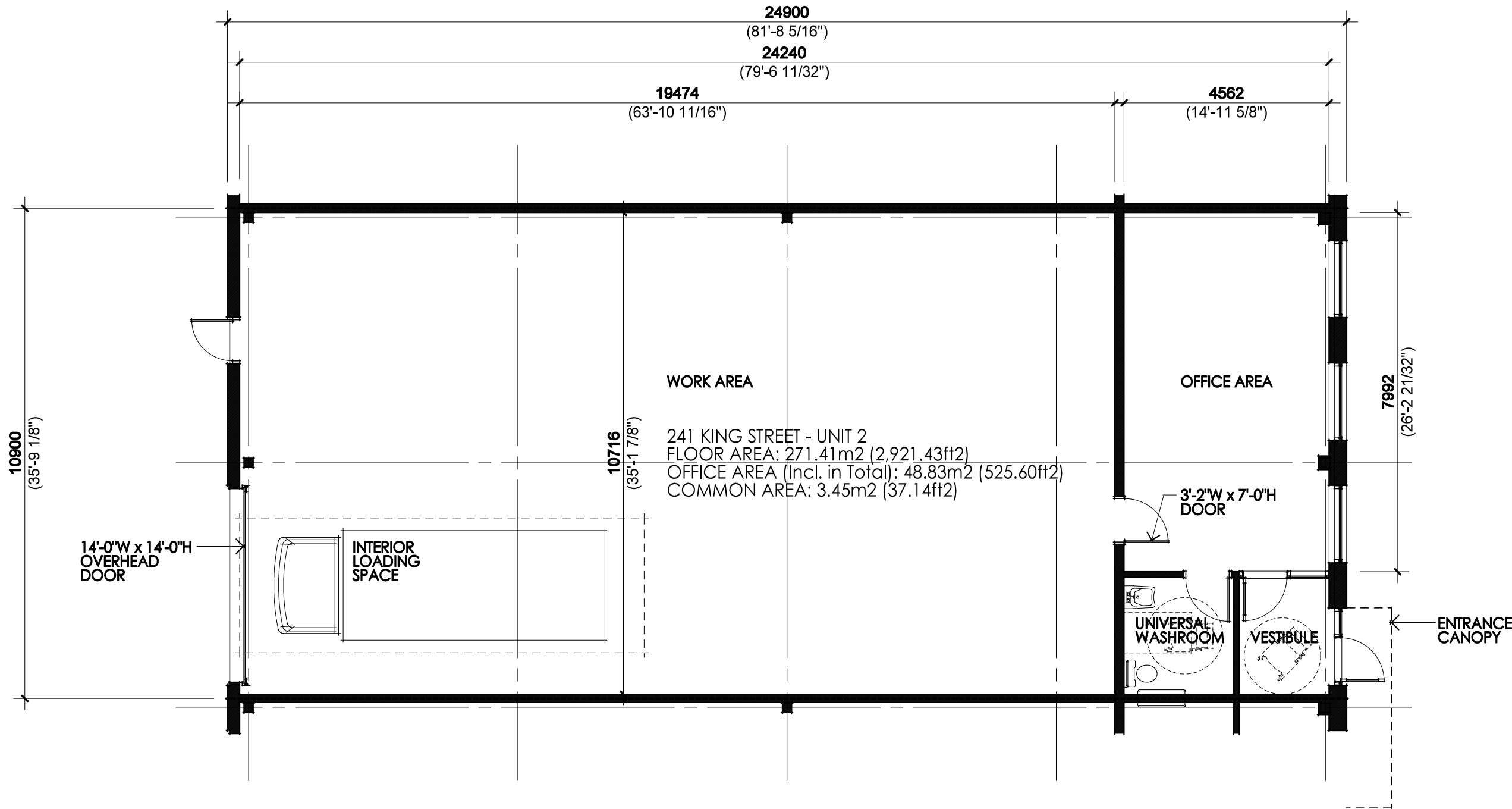

WORK AREA

OFFICE AREA

241 KING STREET - UNIT 2
 FLOOR AREA: 271.41m² (2,921.43ft²)
 OFFICE AREA (Incl. in Total): 48.83m² (525.60ft²)
 COMMON AREA: 3.45m² (37.14ft²)

3'-2" W x 7'-0" H
 DOOR

UNIVERSAL
 WASHROOM

VESTIBULE

ENTRANCE
 CANOPY

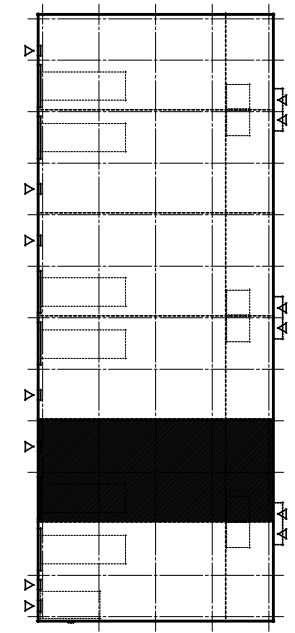

KEY PLAN

10900
 (35'-9 1/8")

10716
 (35'-1 7/8")

7992
 (26'-2 2/32")

24900
 (81'-8 5/16")
 24240
 (79'-6 11/32")

19474
 (63'-10 11/16")

4562
 (14'-11 5/8")

14'-0" W x 14'-0" H
 OVERHEAD
 DOOR

INTERIOR
 LOADING
 SPACE

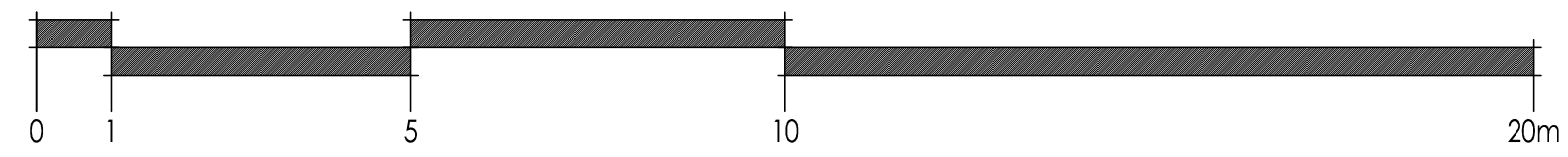

owner
2310481 ONTARIO INC.
 1405 Denison Street
 Markham, Ontario, L3R 5V2

project name
INDUSTRIAL BUILDING
 241 King Street, Barrie, Ontario

WHEELWRIGHT GROUP INC.
 ENGINEERS AND CONTRACTORS
 110 FENMAR DRIVE
 TORONTO, ONTARIO, M9L 1M5
 TEL : (416) 741-2630
 FAX : (416) 741-9059

scale 1 : 100
 drawn DM
 date October 2022
 checked

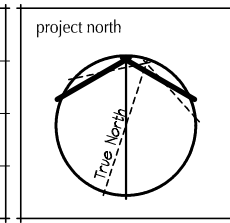

title
 MARKETING
 FLOOR PLAN
 UNIT 2

project & drawing no.
 21-511
MFP-2

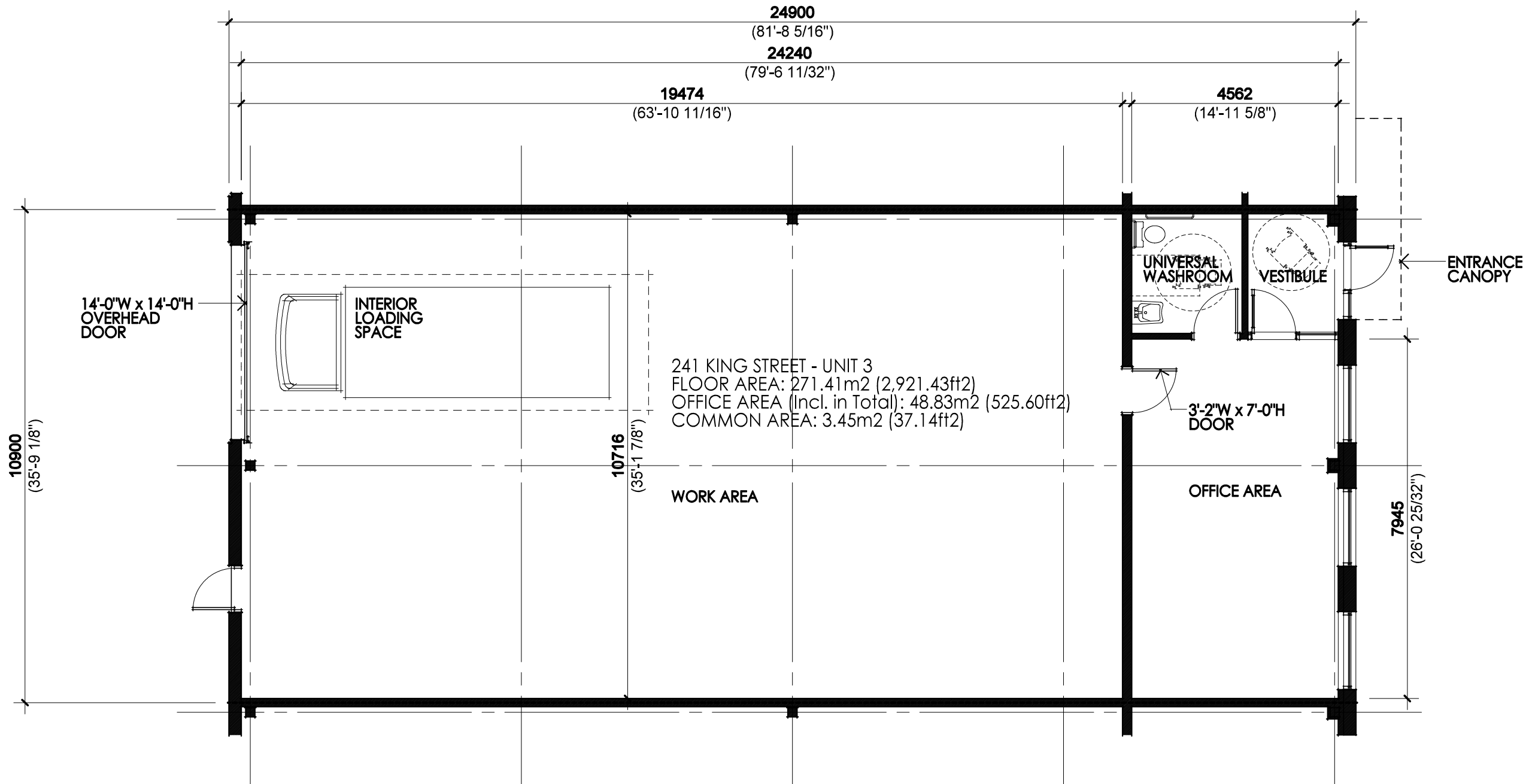

241 KING STREET - UNIT 3
 FLOOR AREA: 271.41m² (2,921.43ft²)
 OFFICE AREA (Incl. in Total): 48.83m² (525.60ft²)
 COMMON AREA: 3.45m² (37.14ft²)

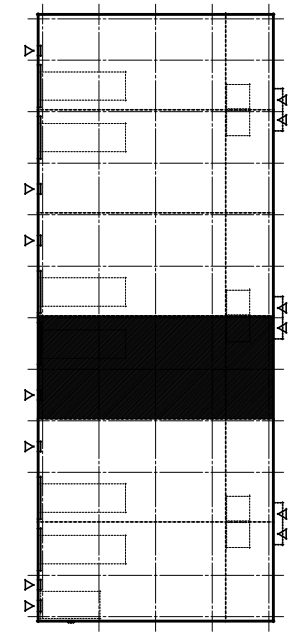

KEY PLAN

10900
(35'-9 1/8")

10716
(35'-1 7/8")

7945
(26'-0 25/32")

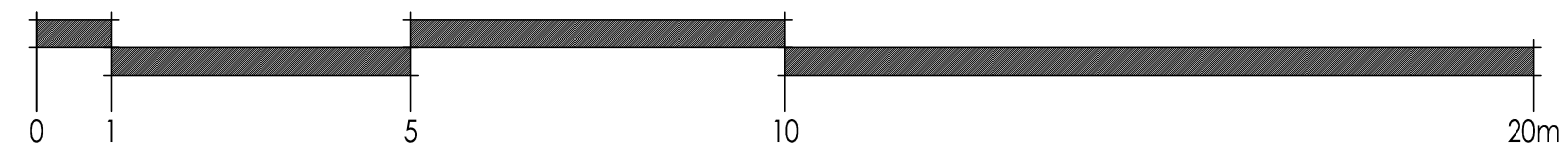

owner
2310481 ONTARIO INC.
 1405 Denison Street
 Markham, Ontario, L3R 5V2

project name
INDUSTRIAL BUILDING
 241 King Street, Barrie, Ontario

WHEELWRIGHT GROUP INC.
 ENGINEERS AND CONTRACTORS
 110 FENMAR DRIVE
 TORONTO, ONTARIO, M9L 1M5
 TEL : (416) 741-2630
 FAX : (416) 741-9059

scale 1 : 100
 drawn DM
 date October 2022
 checked

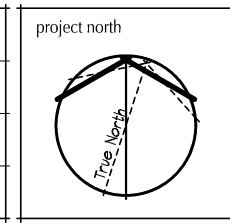

title
MARKETING FLOOR PLAN UNIT 3

project & drawing no.
 21-511
MFP-3

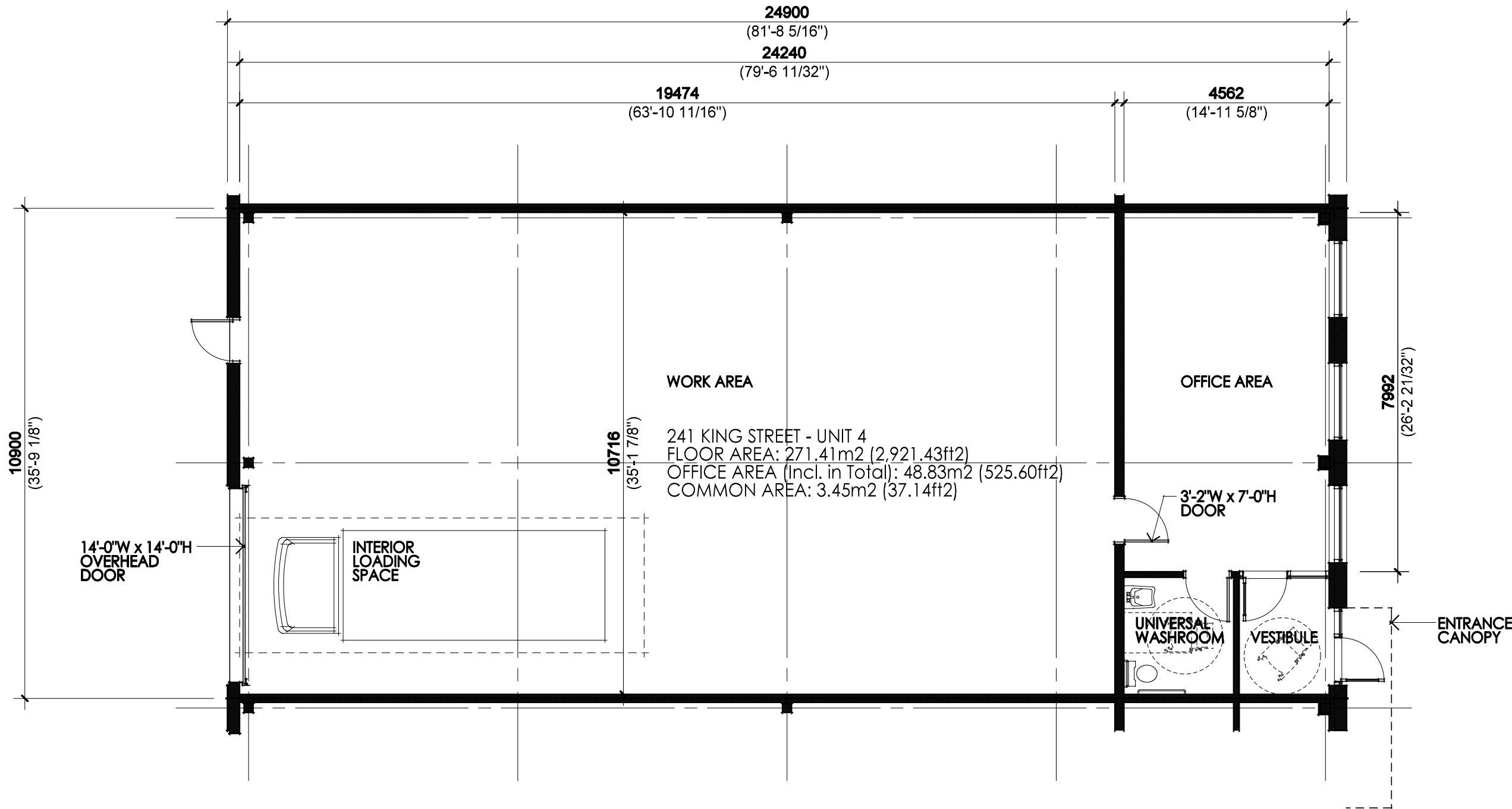

WORK AREA

OFFICE AREA

241 KING STREET - UNIT 4
 FLOOR AREA: 271.41m² (2,921.43ft²)
 OFFICE AREA (Incl. in Total): 48.83m² (525.60ft²)
 COMMON AREA: 3.45m² (37.14ft²)

UNIVERSAL WASHROOM

VESTIBULE

ENTRANCE CANOPY

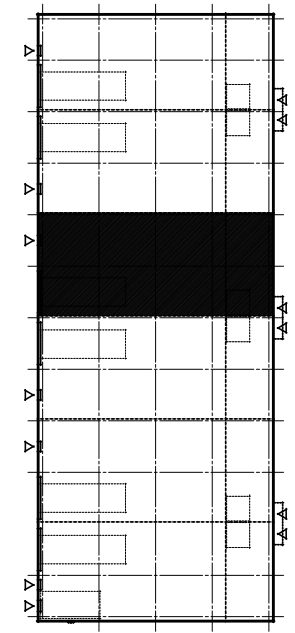

KEY PLAN

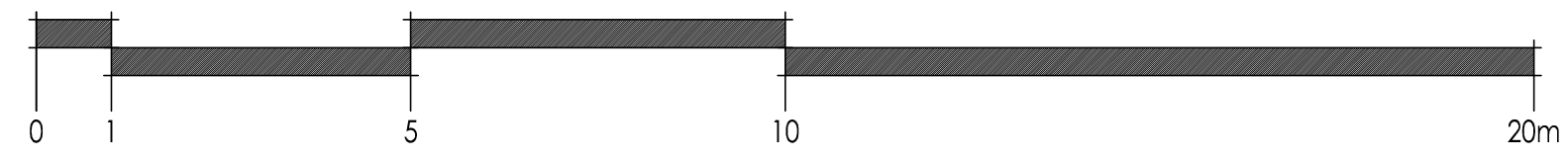

owner
2310481 ONTARIO INC.
 1405 Denison Street
 Markham, Ontario, L3R 5V2

project name
INDUSTRIAL BUILDING
 241 King Street, Barrie, Ontario

WHEELWRIGHT GROUP INC.
 ENGINEERS AND CONTRACTORS
 110 FENMAR DRIVE
 TORONTO, ONTARIO, M9L 1M5
 TEL : (416) 741-2630
 FAX : (416) 741-9059

scale 1 : 100
 drawn DM
 date October 2022
 checked

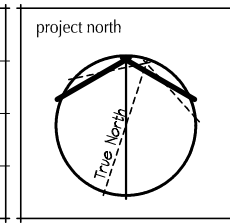

title
MARKETING FLOOR PLAN UNIT 4

project & drawing no.
 21-511
MFP-4

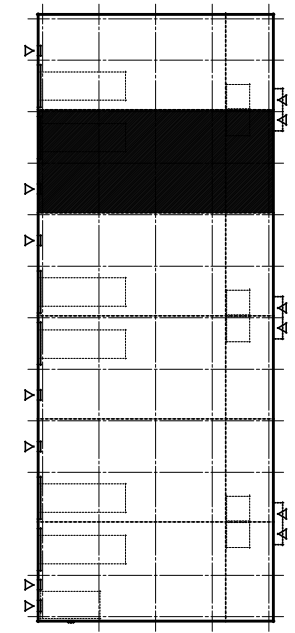
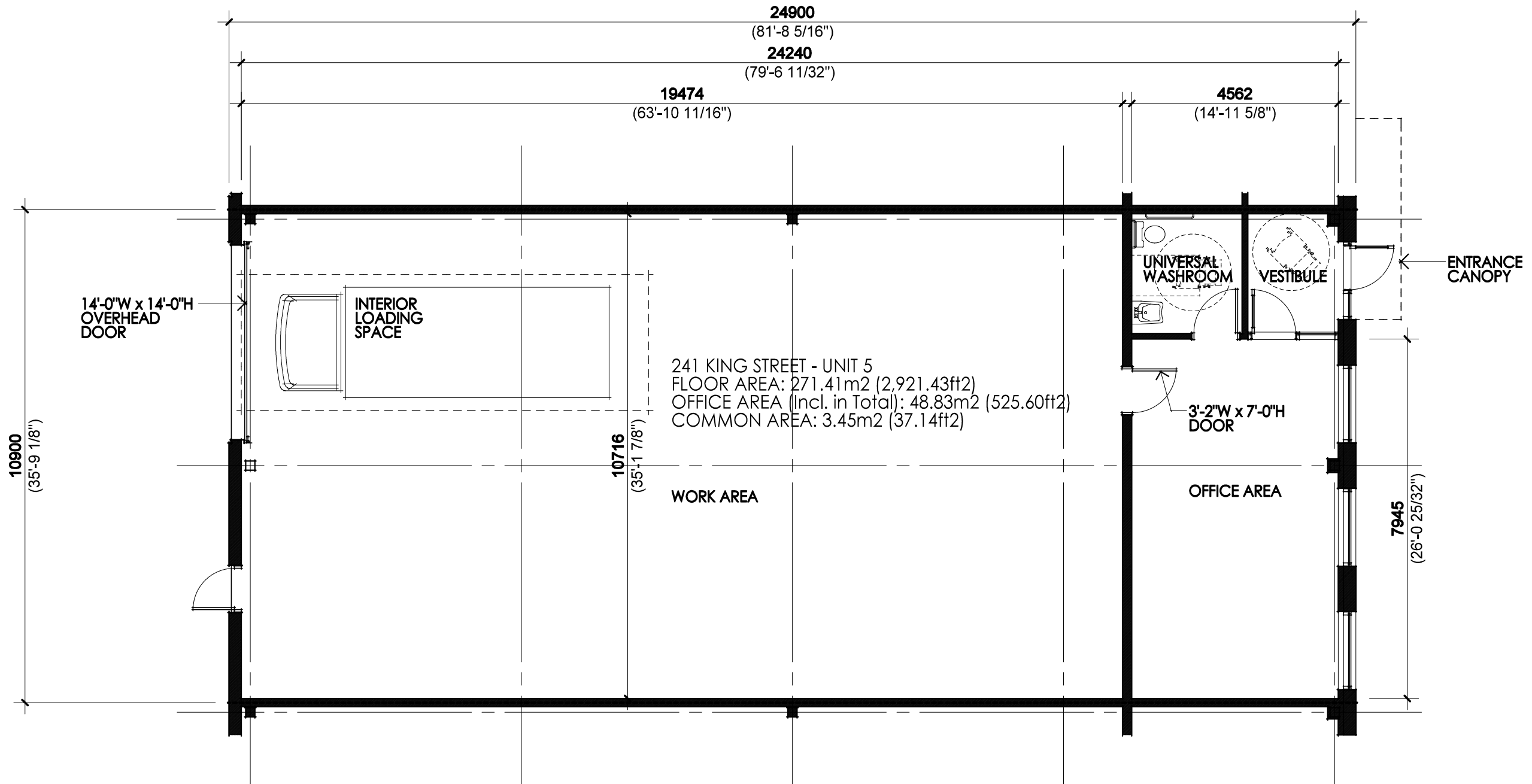

KEY PLAN

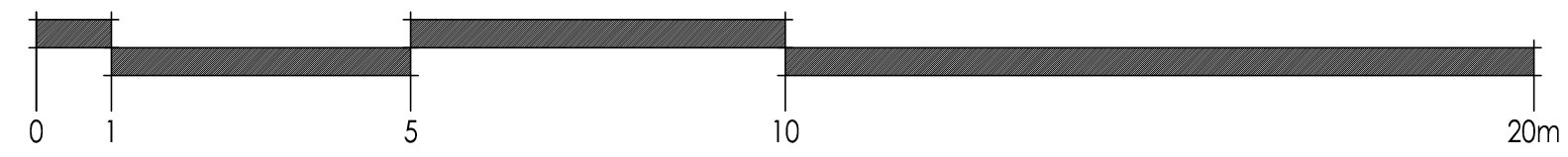

owner
2310481 ONTARIO INC.
 1405 Denison Street
 Markham, Ontario, L3R 5V2

project name
INDUSTRIAL BUILDING
 241 King Street, Barrie, Ontario

WHEELWRIGHT GROUP INC.
 ENGINEERS AND CONTRACTORS
 110 FENMAR DRIVE
 TORONTO, ONTARIO, M9L 1M5
 TEL : (416) 741-2630
 FAX : (416) 741-9059

scale 1 : 100
 drawn DM
 date October 2022
 checked

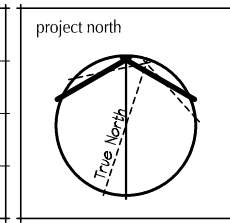

title
 MARKETING
 FLOOR PLAN
 UNIT 5

project & drawing no.
 21-511
MFP-5

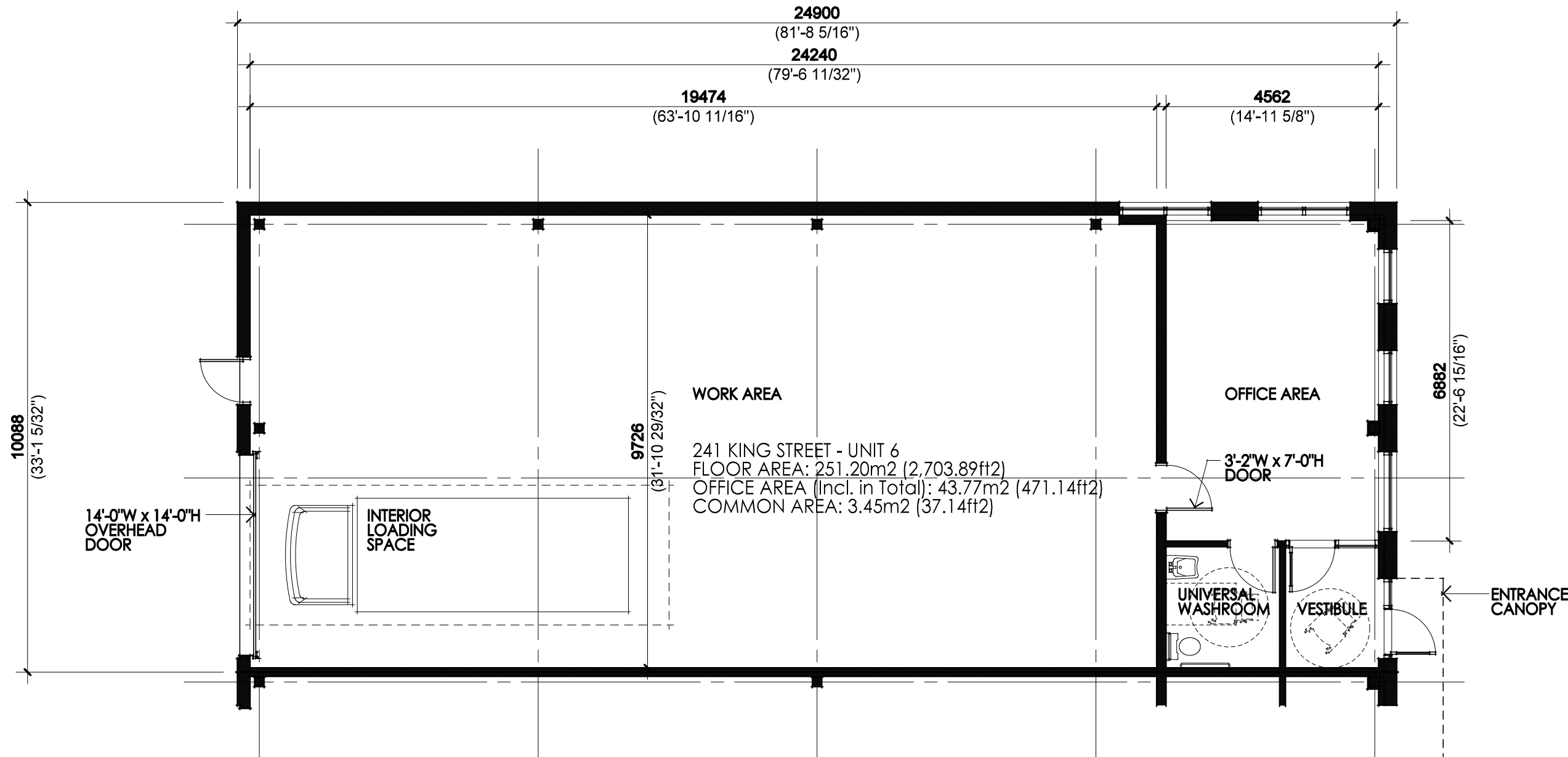

241 KING STREET - UNIT 6
 FLOOR AREA: 251.20m² (2,703.89ft²)
 OFFICE AREA (Incl. in Total): 43.77m² (471.14ft²)
 COMMON AREA: 3.45m² (37.14ft²)

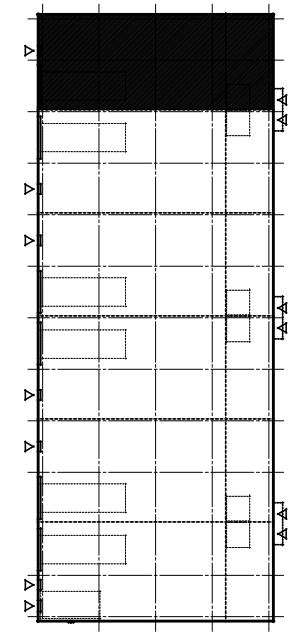

KEY PLAN

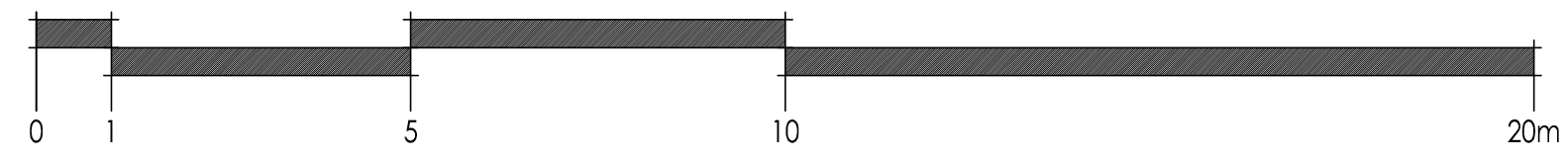

owner	
2310481 ONTARIO INC. 1405 Denison Street Markham, Ontario, L3R 5V2	
project name	
INDUSTRIAL BUILDING 241 King Street, Barrie, Ontario	
WHEELWRIGHT GROUP INC. ENGINEERS AND CONTRACTORS 110 FENMAR DRIVE TORONTO, ONTARIO, M9L 1M5 TEL : (416) 741-2630 FAX : (416) 741-9059	
scale	1 : 100
drawn	DM
date	October 2022
checked	
project north	
title	MARKETING FLOOR PLAN UNIT 6
project & drawing no.	21-511 MFP-6