

BOURN QUARTER

CAMBRIDGE · CB23 7FW

RESEARCH & DEVELOPMENT.

LIFE SCIENCES.

PRODUCTION & STORAGE.

MODERN, HIGH
SPECIFICATION UNITS



UNITS 10C - 10F
UP TO 9,681 SQ FT



UNITS 10C - 10F

SPECIFICATION INCLUDES:

GROUND FLOOR

- 1x 4m high x 3.5m wide level access door per unit
- 70kn/m² floor loading
- 7m clear internal height
- Extensive roof lights and warehouse windows
- LED lighting with PIR system throughout
- State of the art VRF heating and cooling system
- High specification WCs

POWER

34 - 52kVA power allocation

EXTERNAL FEATURES

- Car parking
- Motorcycle spaces available
- Cycle storage spaces
- Dedicated car parking spaces and 1 EV charging point per unit
- 11m yard depth

ENVIRONMENTAL

- EPC A
- BREEAM EXCELLENT
- High-tech remote energy monitoring system with online portal

Unit 10F benefits from a high quality office fit out, spread over ground and first floors

Bourn Quarter is a best-in-class development - a scheme that has prioritised sustainability and efficiency above all else - offering space for a broad spectrum of businesses requiring R&D, light manufacturing, office and warehouse facilities.

**BOURN
QUARTER**

COVERED CYCLE STORAGE

34 - 52kVA
POWER ALLOCATION

7M CLEAR EAVES
HEIGHT



UNITS 10C - 10F

UP TO 9,681 SQ FT

REFURBISHED UNITS

UNIT	SQ M	SQ FT
UNIT 10C	149.9	1,614
UNIT 10D	149.8	1,612
UNIT 10E	149.8	1,612
UNIT 10F		
Ground Floor	227	2,443
First Floor	223	2,400
TOTAL	899.5	9,681

Approximate area sizes

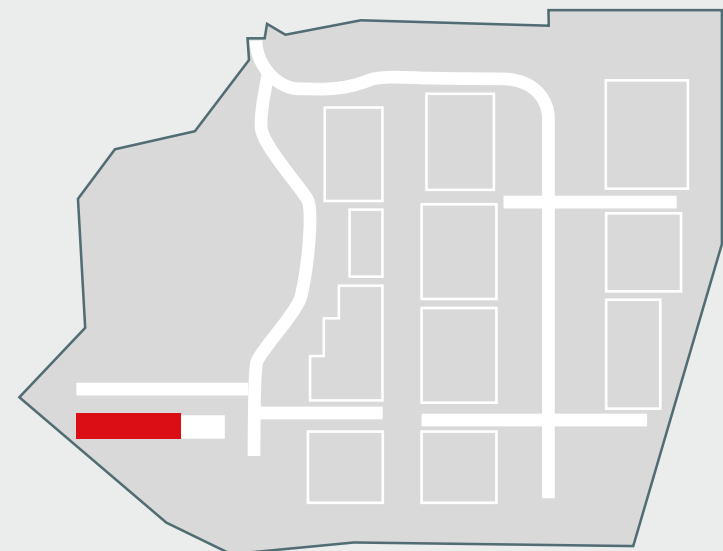

UNITS 10C - 10F

FLEXIBLE AND ADAPTABLE SPACE

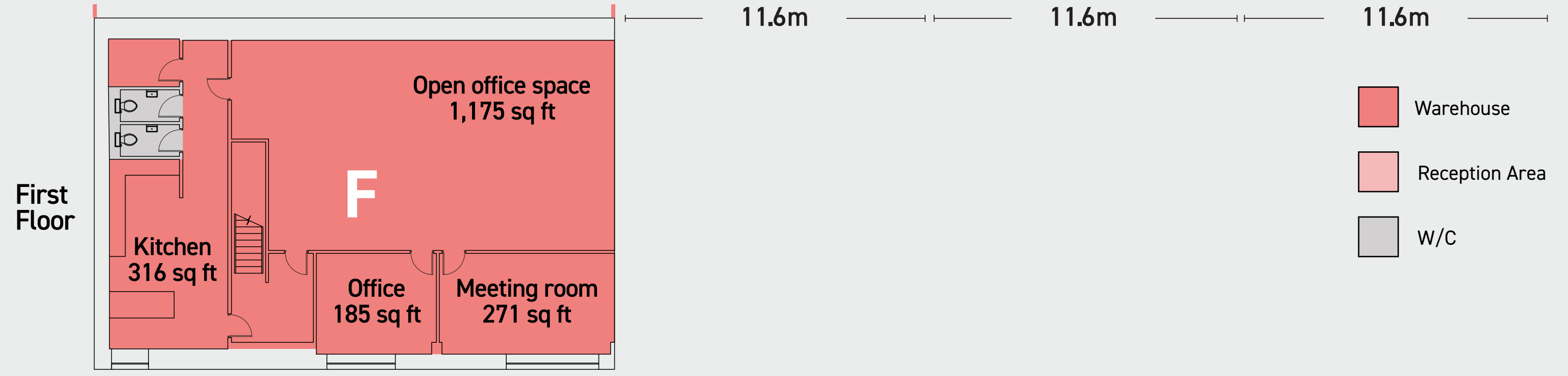
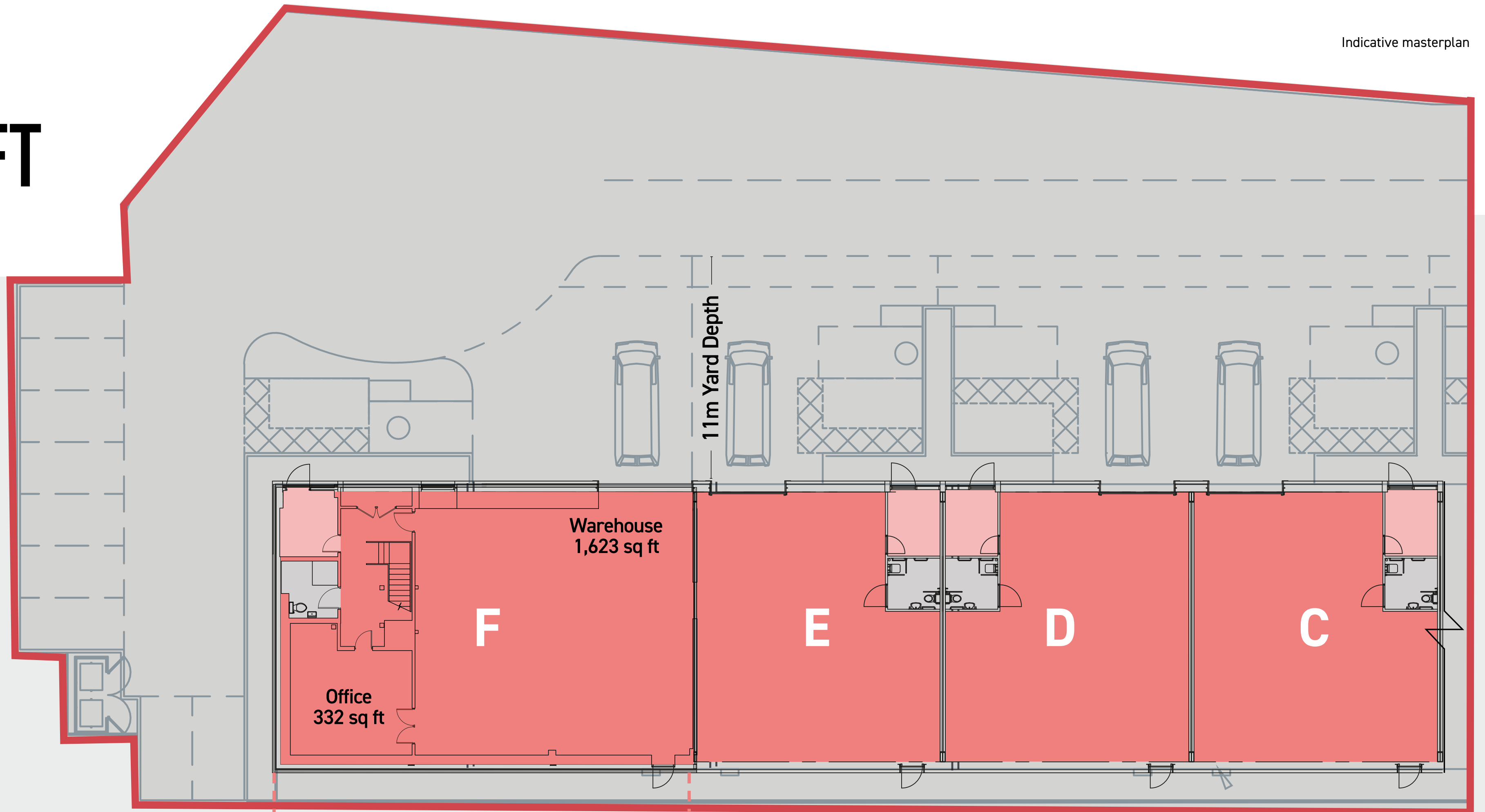

- Warehouse
- Reception Area
- w/c

savills.co.uk 
01223 347 000

CHEFFINS
 01223 213666

DTRE
020 3328 9080
www.dtre.com

Megan Pilsworth
 07976 910 469
mpilsworth@savills.com

Phillip Ridoutt
 07807 999 036
pridoutt@savills.com

Ross Hemmings
 07890 423 803
ross.hemmings@savills.com

Luke Davenport
 07912 656 575
luke.davenport@cheffins.co.uk

Alexander Smith
 07827 134 685
alexander.smith@cheffins.co.uk

Jamie Green
 07776 161 534
jamie.green@dtre.com

Sam Cooper
 07880 585 950
sam.cooper@dtre.com



CAMBRIDGE · CB23 7FW **SAT NAV: CB23 7FW** [///DATE.DIAGRAM.ASSESS](http://DATE.DIAGRAM.ASSESS)

A development by:

Mortimer/RE



BOURN-QUARTER.COM

Important Notice Savills, Cheffins, DTRE and their clients give notice that: 1. They are not authorised to make or give any representations or warranties in relation to the property either here or elsewhere, either on their own behalf or on behalf of their client or otherwise. They assume no responsibility for any statement that may be made in these particulars. These particulars do not form part of any offer or contract and must not be relied upon as statements or representations of fact. 2. Any areas, measurements or distances are approximate. The text, photographs and plans are for guidance only and are not necessarily comprehensive. It should not be assumed that the property has all necessary planning, building regulation or other consents and Savills have not tested any services, equipment or facilities. Purchasers must satisfy themselves by inspection or otherwise. J018435 03.26 tasselldesign.co.uk