

2 PARTITION TYPE 3" = 1'-0"
ONE-HOUR FIRE RATED - UL LISTING: U411

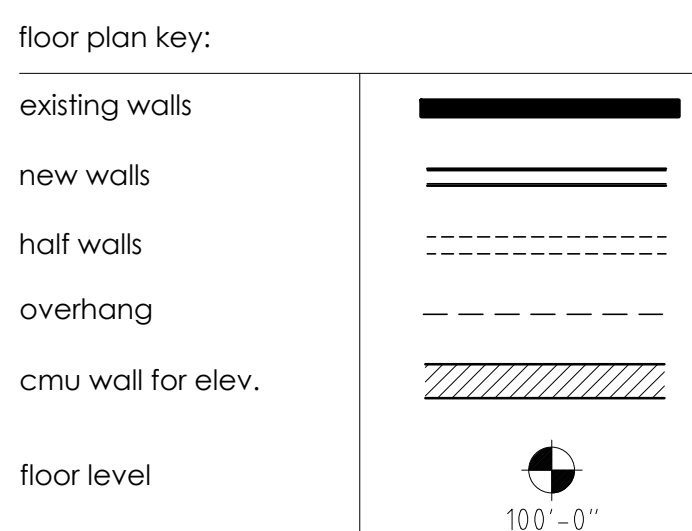

- floor plan notes:
- the contractor shall verify all existing conditions prior to the commencement of work. any discrepancies shall be brought to the attention of the owner & designer.
 - all new typical interior walls are to be 3 3/8" or 6" metal stud @ 16" o.c. or u.n.o with typical 5/8" thick gypsum board.
 - ensure wall blocking is available for any wall mounting element. reference all sheets and elevations as required.
 - reference wall section details for different wall types and conditions

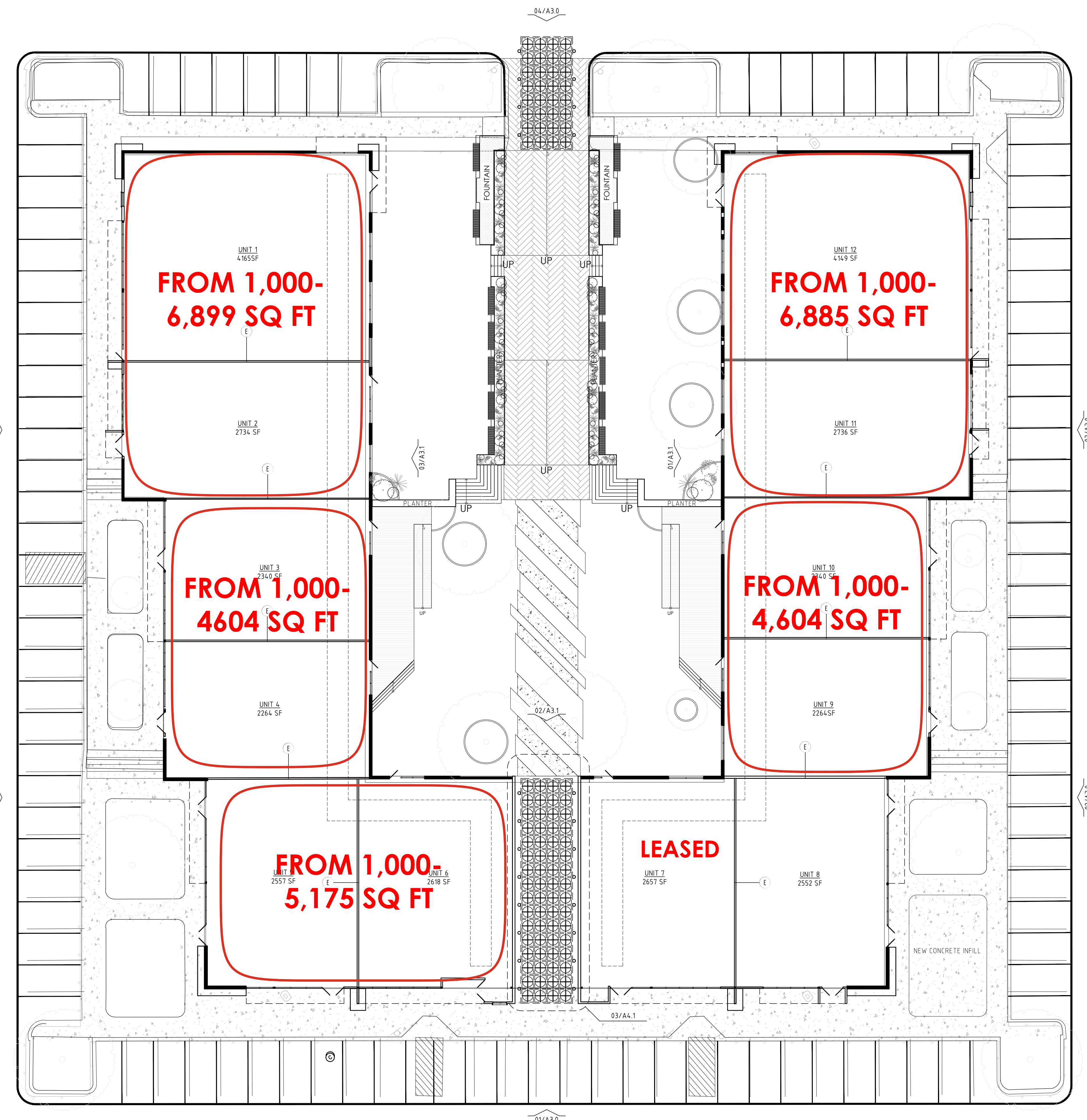

01 floor plan 1/16" = 1'-0" north

PROJECT TEAM:
OWNER
AJ Real Estate Investments
3265 Broadway Blvd, Suite 100
Garland, TX 75043
214.728.1881

DESIGN TEAM / ARCHITECTURE
Coeval Studio
2005 Farrington St.
Dallas, Texas 75207
214.931.4097 - Office

STRUCTURAL ENGINEER
McGinnis Civil
625 South Bois D Arc Ave,
Tyler, Texas 75701
903.245.7065
mjm@mcginniscivil.com

MEP ENGINEER
A F Elgin & Associates
816 April Sound Ct, Suite 200
Fl. Worth, Texas 76120
817.929.2373
arthur.elgin@afelgin.com

LANDSCAPE ARCHITECT
David L. Garrison Landscape Design Studio
4445 Eldorado Dr
Plano, Texas 75093
214.668.4163
david@planlandscapes.com

IRRIGATION
R. Pickering Design Service, LLC
200 Country Brook Dr Apt 2425
Keller, TX 76248
214.549.8111
bob@pickering.com

CIVIL ENGINEER
Hamilton Civil Engineering
lawrence.hamilton89@gmail.com

GEOTECH
TSIT Engineering & Consulting, LLC.
2211 Century Center Blvd, Ste 101
Irving, Texas 75062
469.503.2183
Hgonzalez@tsitengineering.com

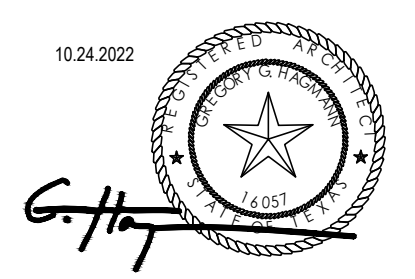

These drawings and copies are the copyrighted property of Coeval Studio. They may not be used for projects other than the designed project without the specific written approval of Coeval Studio.

COEVAL
www.coevalstudio.com
info@coevalstudio.com
copyright © all rights reserved 2022

Garland Project
13755 Lyndon B Johnson Freeway,
Garland, Texas 75041

PROJECT NUMBER
22008
REVISIONS

ISSUE DATE
10.24.2022
PERMIT SET

FLOOR PLAN
A2.0-A