

Lambert  
Smith  
Hampton



**WIRRAL**

**FOR  
SALE**

# **WALLASEY & BIRKENHEAD TOWN HALLS**





**WALLASEY TOWN HALL** | BRIGHTON STREET | WALLASEY | WIRRAL | CH44 8ED | **AND**  
**BIRKENHEAD TOWN HALL** | MORTIMER STREET | BIRKENHEAD | WIRRAL | CH41 5EU |

**SITUATION**



# OPPORTUNITY OVERVIEW

## 1. WALLASEY TOWN HALL

- 84,643 sq ft (7,863.5 sq m)
- 2.713 acres
- Freehold (MS569035)
- Grade II\* listed

/// [august.perky.rust](https://www.august.perky.rust.com)



1. WALLASEY TOWN HALL

## 2. BIRKENHEAD TOWN HALL

- 47,524 sq ft (4,415 sq m)
- 0.516 acres
- Freehold (MS564326)
- Grade II\* listed

/// [dawn.milky.wings](https://www.dawn.milky.wings.com)



2. BIRKENHEAD TOWN HALL

WALLASEY TOWN HALL | BRIGHTON STREET | WALLASEY | WIRRAL | CH44 8ED | **AND**  
BIRKENHEAD TOWN HALL | MORTIMER STREET | BIRKENHEAD | WIRRAL | CH41 5EU |



# 1. WALLASEY TOWN HALL



WALLASEY TOWN HALL | BRIGHTON STREET | WALLASEY | WIRRAL | CH44 8ED |

**SITE EXTERIOR**



# 1. WALLASEY TOWN HALL



WALLASEY TOWN HALL | BRIGHTON STREET | WALLASEY | WIRRAL | CH44 8ED |

**SITE INTERIOR**



# 1. WALLASEY TOWN HALL

## ACCOMMODATION

### Gross Internal Areas

Floor	Sq Ft	Sq M
Basement	14,962	1,390
Ground	23,608	2,193.2
First	23,605	2,193
Second	15,751	1,463.3
Third	6,717	624
<b>Total</b>	<b>84,643</b>	<b>7,863.5</b>

The property comprises a Grade II\* listed municipal building located on Brighton Street, Wallasey overlooking the River Mersey constructed in 1916. A number of key civic functions are currently operating from Wallasey Town Hall, along with the Registrar and Licencing services.

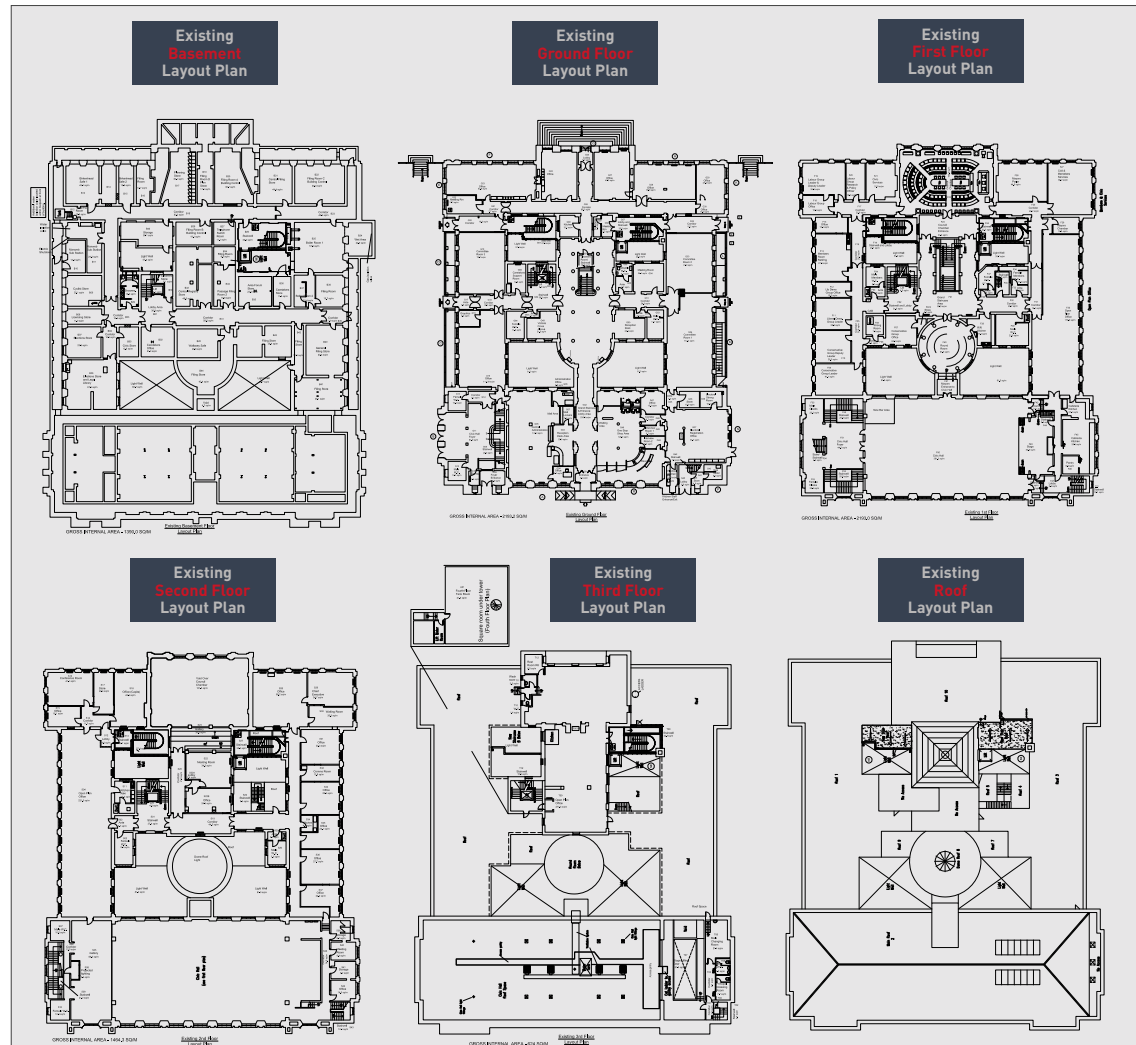

Basement, Ground Floor, 1st Floor, 2nd Floor, Third Floor and Roof provide an indicative layout. The full floor plans can be downloaded from the dataroom.

/// [august.perky.rust](http://august.perky.rust)



## 2. BIRKENHEAD TOWN HALL



Photo by Gary Bear.



## 2. BIRKENHEAD TOWN HALL



## 2. BIRKENHEAD TOWN HALL ACCOMMODATION

### Gross Internal Areas

Floor	Sq Ft	Sq M
Ground	15,005	1,394
First	14,015	1,302
Second	14,155	1,315
Third	4,349	404
<b>Total</b>	<b>47,524</b>	<b>4,415</b>

The property comprises a Grade II\* listed building fronting Hamilton Square, Birkenhead constructed in 1887. The asset is current non operational and civic functions were relocated in 2025.

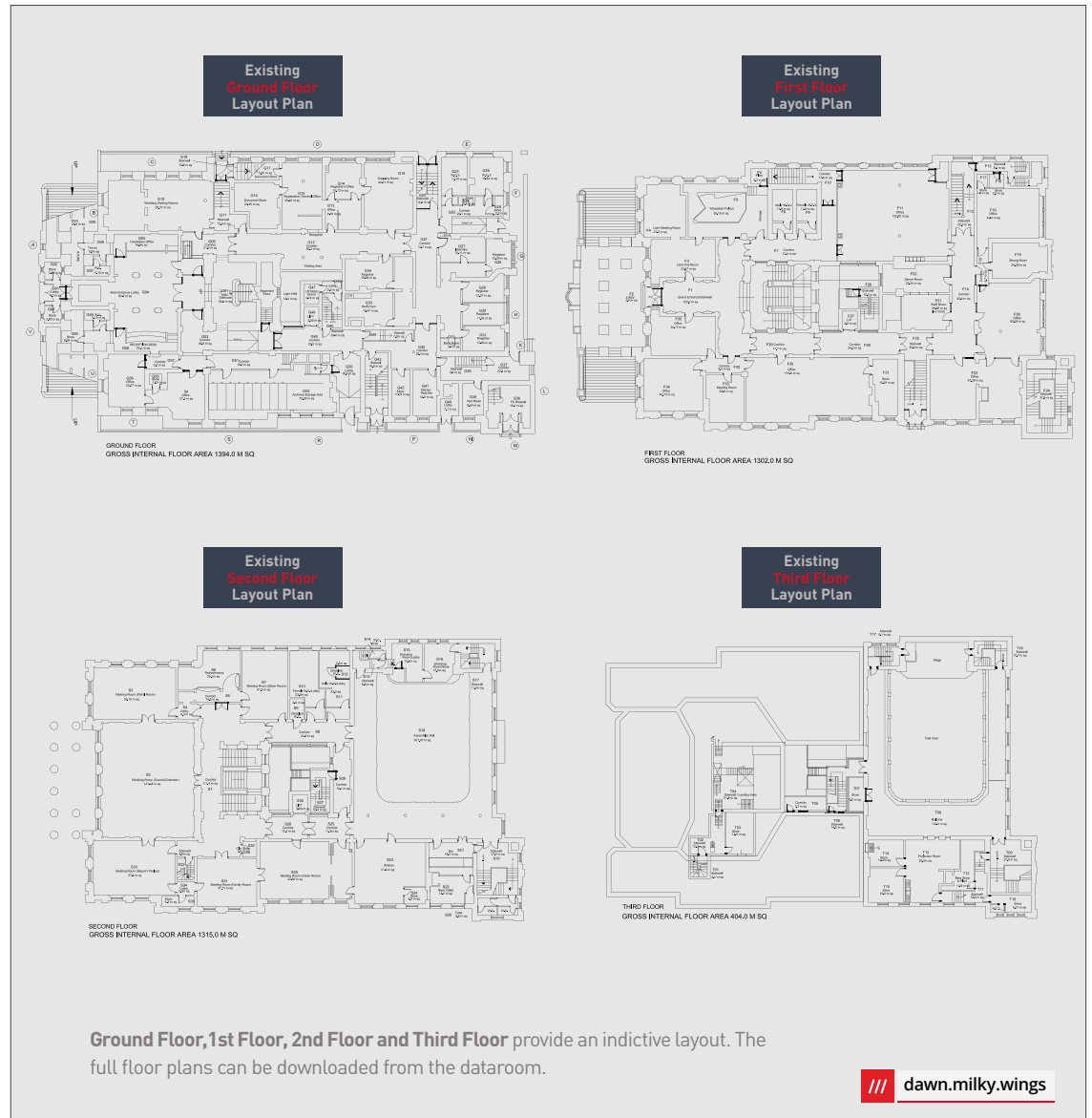

# SALE DISPOSAL PROCESS & BASIS OF OFFER

To appoint a suitable purchaser of the individual or combined assets, the Council is required to seek internal approvals to proceed with a disposal

## ■ Stage 1 – Registration of Interest

Register for access to the dataroom by emailing [jstrong@lsh.co.uk](mailto:jstrong@lsh.co.uk)

## ■ Stage 2 – Bid Submission

Offers are invited to acquire the freehold interest(s) with vacant possession. Where a conditional bid is proposed, any conditions of offer must be clearly stated. All bidders are required to complete the Bid Submission Template which will be made available at a later date. Bidders should submit their bid by email to James Strong ([jstrong@lsh.co.uk](mailto:jstrong@lsh.co.uk)) at Lambert Smith Hampton. All offers are subject to contract.

■ The Vendor is not bound to accept the highest or any offer and reserves the right to enter into negotiations with any party.

## BID DEADLINE

Offers will be invited on a set date to be advised separately.

## TENURE

**Wallasey Town Hall**, the site is held freehold under title **MS569035**.

**Birkenhead Town Hall**, the site is held freehold under title **MS564326**.

Title information is contained within the dataroom for consideration.

## VAT

The client advises that VAT will not be applicable on this sale.

## FILE SHARE

A dataroom is available by request from the sole agent.

## ANTI – MONEY LAUNDERING

The selected purchaser will need to be validated for money laundering regulations.

## SUBJECT TO CONTRACT

# CONTACTS

James Strong

E: [jstrong@lsh.co.uk](mailto:jstrong@lsh.co.uk)

M: 07484 306 821

Lambert  
Smith  
Hampton

4th Floor - Windmill Green,  
24 Mount Street,  
Manchester, M2 3NN

[lsh.co.uk](http://lsh.co.uk)



Office: +44(0) 161 228 6411

## VIEWINGS

The site is open to see from the public highway, however onsite inspection is strictly by appointment with the sole selling agent **LSH**. A viewing day will be announced separately.

DISCLAIMER: (i) These particulars are given and any statement about the property is made without responsibility on the part of LSH or the seller or landlord and do not constitute the whole or any part of an offer or contract. (ii) Any description, dimension, distance or area given or any reference made to condition, working order or availability of services or facilities, fixtures or fittings, any guarantee or warranty or statutory or any other permission, approval or reference to suitability for use or occupation, photograph, plan, drawing, aspect or financial or investment information or tenancy and title details or any other information set out in these particulars or otherwise provided shall not be relied on as statements or representations of fact or at all and any prospective buyer or tenant must satisfy themselves by inspection or otherwise as to the accuracy of all information or suitability of the property. (iii) No employee of LSH has any authority to make or give any representation or warranty arising from these particulars or otherwise or enter into any contract whatsoever in relation to the property in respect of any prospective purchase or letting including in respect of any re-sale potential or value or at all. (iv) Price or rent may be subject to VAT and any prospective buyer or tenant must satisfy themselves concerning the correct VAT position. (v) Except in respect of death or personal injury caused by the negligence of LSH or its employees or agents, LSH will not be liable, whether in negligence or otherwise howsoever, for any loss arising from the use of these particulars or any information provided in respect of the property save to the extent that any statement or information has been made or given fraudulently by LSH. (vi) In the case of new development or refurbishment prospective buyers or tenants should not rely on any artists' impressions or architects' drawings or specification or scope of works or amenities, infrastructure or services or information concerning views, character or appearance and timing concerning availability or occupation and prospective buyers or tenants must take legal advice to ensure that any expectations they may have are provided for direct with the seller or landlord and LSH shall have no liability whatsoever concerning any variation or discrepancy in connection with such matters. **April 2026.**

ON BEHALF OF:

 **WIRRAL**

**WALLASEY TOWN HALL** | BRIGHTON STREET | WALLASEY | WIRRAL | CH44 8ED | **AND**  
**BIRKENHEAD TOWN HALL** | MORTIMER STREET | BIRKENHEAD | WIRRAL | CH41 5EU |