

SUITE #240 B
3,577 RSF +/-



SUITE #240
SCALE: 3/32" = 1'-0"
(11 x 17 PAPER)

5,461 RSF

Legend:

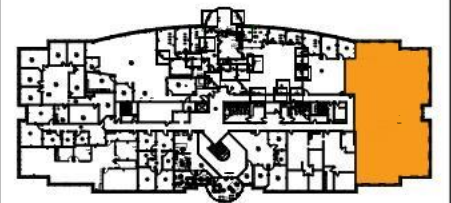

KEY PLAN

no.	issue	date

Title: **KEYSTONE OFFICE PARK**
2nd FLOOR PLAN

Scale: N.T.S.

Drawn By: _____

Date: _____

Project Name and Location:

3077 EAST 98TH STREET
CARMEL INDIANA

Suite/Room #

240

80 Monroe Avenue,
Suite L-7
Memphis, TN, 38103
Tel: 1-888-OLYMBEC
WWW.OLYMBEC.COM

*Note That All Dimensions Are Approximate and subject to change without notice