

Sutton in Ashfield

Beecroft Park, Penny Emma Way, Sutton in Ashfield, NG17 5FA



TO LET / FOR SALE

18,300 TO 85,400 SQ FT
(1,700.13 TO 7,933.92 SQ M)

5.8 acre prime industrial development site at J28 M1. Available on design and build basis

- High Power Supply
- 3.5 miles from Junction 28 of the M1 Motorway
- Fully Serviced Development Land
- Substantial infrastructure in place

01604 604020
tdbre.co.uk

Beecroft Park

Penny Emma Way, Sutton in Ashfield, NG17 5FA

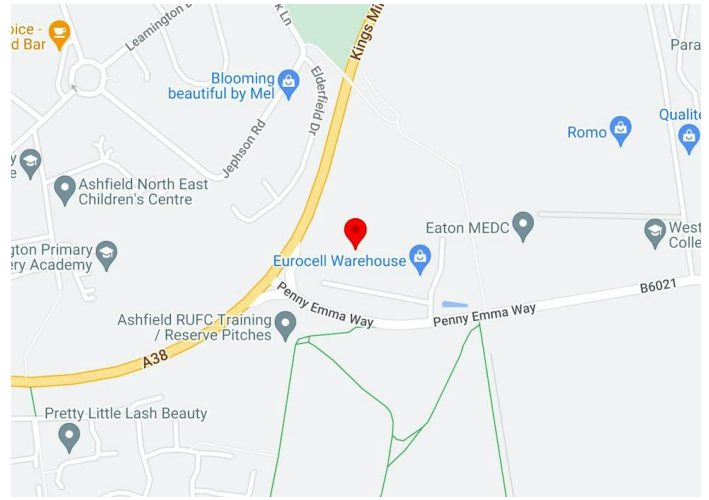
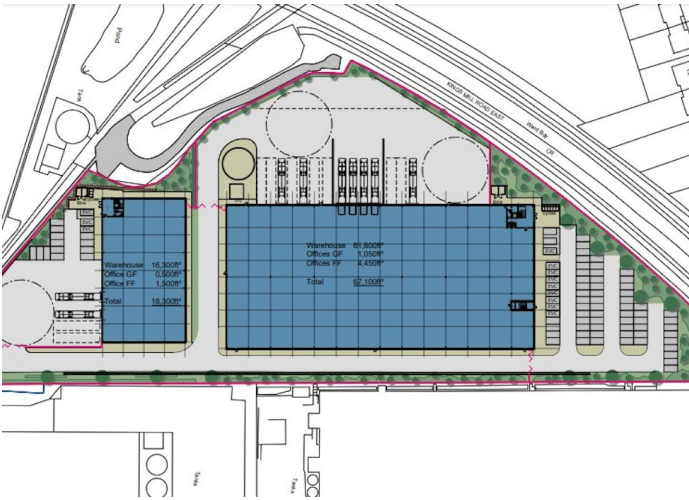

Summary

Available Size	18,300 to 85,400 sq ft / 1,700.13 to 7,933.92 sq m
Rent	Leasehold terms are available on request
Price	Freehold terms are available on request
Estate Charge	TBC
EPC	Upon Enquiry

Description

A fully serviced 5.8 acre prime industrial development site capable of providing design and build opportunities of up to 85,400 sq ft on a freehold or leasehold D&B basis, terms are available on request.

Mains water, electricity (800kva) and gas available. A higher electricity loading supply can be made available at a modest additional cost. Further details upon request

Location

This prestigious new development is easily accessible from junction 28 of the M1 Motorway and A38 Kings Mill Road East, close to the junction with Penny Emma Way and the Oddcroft Lane Industrial Estate.

J28 Beecroft Park is 16 miles north of Nottingham with Mansfield situated to the north east.

Accommodation

Indicative accommodation comprises the following areas:

Name	sq ft	sq m	Availability
Unit - Unit 1	18,300	1,700.13	Available
Unit - Unit 2	67,100	6,233.79	Available
Total	85,400	7,933.92	



Oliver Thompson

01604 604 020 | 07837 191 054

oliver@tdbre.co.uk

